

2026-03-16

IFC R1 - March 2026

Spruce + Arrow Design Co.  
250-814-3822  
designs@spruceandarrow.ca  
Unit 2, 616 3rd St. W. Revelstoke BC.



## BENCHLANDS TOWNHOMES - SELECTIONS PACKAGE

Colour Scheme 2 - FLORA (*Blue/Cool Tones/Airy/Natural*)



### R4 Updates

- H1 - Hardwood - Type + Wear Layer
- T5 - Accent Tile
- Shower Base (with curb)
- MW4 - Cabinet Material (Pantry/Closet Units)
- CT2 - Butcher Block Counters (Pantry + Laundry)
- Shower Door = Slider w/ Return (Bathroom 5)
- Remove Washer/Dryer Pedestals
- Fireplace spec change
- ALL Tile Layout/Pattern
- Blind Spec

Scheme - FLORA

Spruce + Arrow Design Co.  
250-814-3822  
designs@spruceandarrow.ca  
Unit 2, 616 3rd St. W. Revelstoke BC.



SPRUCE + ARROW  
INTERIOR DESIGN STUDIO

MARKETING RENDERINGS



Kitchen Rendering



Living + Dining Rendering



Bathroom Rendering



SPRUCE + ARROW  
INTERIOR DESIGN STUDIO

BATHROOM TYPE LEGEND

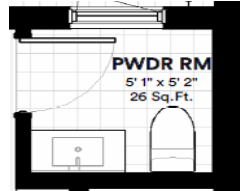

BATHROOM 1  
2-Piece Powder Bath

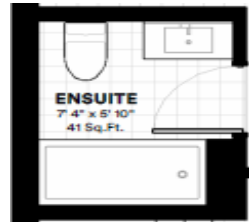

BATHROOM 2  
Standard 3-Piece Bath

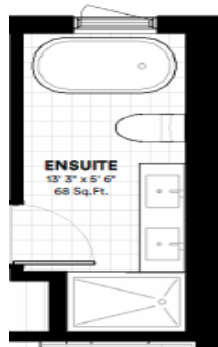

BATHROOM 3  
5-Piece Primary Ensuite (center 20' wide units)

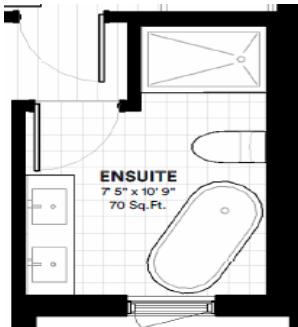

BATHROOM 4  
5-Piece Primary Ensuite (center 20' wide units)

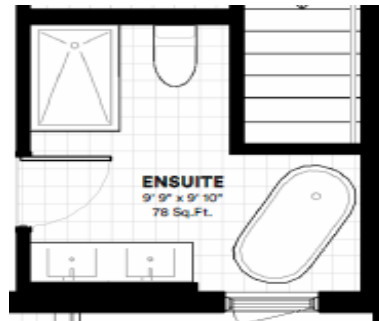

BATHROOM 5  
5-Piece Primary Ensuite (end 24' wide units)



CLIENT: Northland Properties - Benchlands Townhomes  
EMAIL: lmcintyre@revelstokemountainresort.com  
DATE: 2026-03-16

For Budgeting Purposes Only

Designer's Rep/Supplier: Colby Russell @ Revelstoke United Floors - colby@revelstokeunitedfloors.ca

## 1 - FLOORING + TILE

### H1 - HARDWOOD

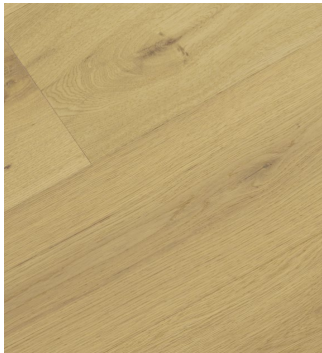

NAME: Engineered Hardwood Floors - **Signature Line**  
COLOUR/FINISH: Avondale, Brushed Texture, DuRa finish ultra matte  
BRAND: Urban Wood / Craft Flooring  
DIMENSIONS: 7.5"W, 75" plank lengths x 9/16"thk. **3mm wear layer**  
QTY: Contractor to Perform Takeoff's  
NOTES: European Oak (better price point than North American)  
Please refer to drawings for direction of lay

Available in 4 construction platforms (Metro, Di Moda, Signature, or Ovation) which vary in wood grade and lamella/wear layer thickness to meet desired price point)

Please reach out to Brandon @ Craft Floors to develop specification to meet project needs. brandon@craftfloor.com 604-619-2652

30 year warranty (finish), lifetime warranty (structure), GREENGUARD gold/CARB II Compliant



### T1 - WALL TILE *(Kitchen Backsplash - starts on top of quartz backsplash)*

NAME: Karatsu  
COLOUR/FINISH: Chalky  
BRAND: Stone Tile  
CODE: KARA-CHAL-115230-GLOS  
DIMENSIONS: 11.5X23x0.85cm  
QTY: Contractor to Perform Takeoff's  
PATTERN: **Lay as per ID Drawings**  
GROUT: Mapei #5077 Frost Grout  
TILE EDGE: Bright White BW Schluter Edge as necessary (outside edge only)

**T2 - ACCENT WALL TILE** (*Powder Bath 1 - Wall behind vanity + toilet*)

---



NAME: Glace Porcelain Tile  
COLOUR/FINISH: Avio, Gloss Finish  
BRAND: Ames Tile & Stone  
CODE: GLAV38  
DIMENSIONS: 3" x 8"  
QTY: Contractor to Perform Takeoff's  
PATTERN: Lay as per ID Drawings  
GROUT: Mapei #5077 Frost Grout  
TILE EDGE: No tile edge necessary - wall to wall install

**T3 - FLOOR + WALL TILE** (*All bathroom floors, shower floors, and bath/shower walls*)

---



NAME: Pietre Di Paragone Porcelain Tile  
COLOUR/FINISH: Gre Grigio, matte finish  
BRAND: Ames Tile & Stone  
CODE: PDGGM24  
DIMENSIONS: 24" x 24"  
QTY: Contractor to Perform Takeoff's  
PATTERN: Lay as per ID Drawings  
GROUT: Mapei #5103 Cobblestone grout, as tight grout lines as possible  
TILE EDGE: Brushed Nickel Schluter Edge as necessary

**T4 - ACCENT WALL TILE** (*Bathroom 2, 3 + 4 - Feature tub/shower wall tile on long wall /back wall only*)

---



NAME: Truestone Porcelain Tile  
COLOUR/FINISH: Grey, Decori - Matte finish  
BRAND: Ames Tile & Stone  
CODE: TSGRS1224  
DIMENSIONS: 12" x 24"  
QTY: Contractor to Perform Takeoff's  
PATTERN: Lay as per ID Drawings  
GROUT: Mapei #5103 Cobblestone grout, as tight grout lines as possible  
TILE EDGE: Brushed Nickel Schluter Edge as necessary

~~**T5 - ACCENT TILE** (*Primary bathroom 4 - arch frame, curb + niche frame*)~~

---



~~NAME: Studio Marble - 3" x 6"  
COLOUR/FINISH: Bianco Macchiato, Polished Marble  
BRAND: Ames Tile & Stone  
CODE: STB36  
DIMENSIONS: 3" x 6"  
QTY: Contractor to Perform Takeoff's  
PATTERN: Horizontal Brick Lay  
GROUT: Mapei #5077 Frost Grout  
TILE EDGE: No tile edge necessary (real marble)  
Natural marble needs to be sealed.~~

T5 - ACCENT TILE *(Shower/tub back of niche, shower floors)*

---



NAME: Studio Marble - 2" Picket Mosaic  
COLOUR/FINISH: Bianco Macchiato, Polished Marble  
BRAND: Ames Tile & Stone  
CODE: STBMP2  
DIMENSIONS: 2" picket mosaic, 12.5" x 13" sheet  
QTY: Contractor to Perform Takeoff's  
PATTERN: *Lay as per ID Drawings*  
GROUT: Mapei #5077 Frost Grout  
TILE EDGE: No tile edge necessary - back of niche only  
Natural marble needs to be sealed.

SHOWER + TUB DETAILS



SHOWER / TUB NICHES

---

NAME: Custom shower niche w/ quartz frame  
COLOUR/FINISH: CT1 Quartz Frame  
DIMENSIONS: CT1 Quartz Frame, *T5 tile in back wall of niche*  
QTY: Contractor to Perform Takeoff's  
NOTES: See drawings for locations and details



*SHOWER BASE with curb*

---

NAME: *Shower base with curb*  
COLOUR/FINISH: *T3 Tile (Exterior), T5 Tile (Interior) - CT1 Quartz Threshold Cap*  
QTY: *Contractor to Perform Takeoff's*



SHOWER BASE

---

NAME: Custom Shower Base - Flush with Floor  
COLOUR/FINISH: T5 finish  
QTY: Contractor to Perform Takeoff's

SHOWER DRAIN

---



NAME: Square drain - Floral - Schluter Kerdi Drain  
COLOUR/FINISH: Brushed Nickel  
CODE: KDIF4 GRK EBVG D5 or KDIF4 GRK EBCG D5  
DIMENSIONS: 4" square  
QTY: Contractor to Perform Takeoff's  
NOTES: Off set drain to be located under showerhead

CUSTOM SHOWER DETAILS (Primary Bathroom-4)



SHOWER NICHE

---

NAME: Custom shower niche w/ real marble tile back + frame)  
COLOUR/FINISH: T5 frame/return, T6 back  
DIMENSIONS: Niche Approx. 14"H x 24"W X 4-6"D  
QTY: Contractor to Perform Takeoff's  
NOTES: No tile edge necessary—wall to wall install-  
Natural marble needs to be sealed-



ARCHED SHOWER OPENING + CURB

---

NAME: Custom arch framed shower opening with curb-  
COLOUR/FINISH: T4 finish (real stone so no tile edge necessary)  
DIMENSIONS: approx 26" - 30" wide opening  
QTY: Contractor to Perform Takeoff's  
NOTES: No tile edge necessary—natural marble edge  
Natural marble needs to be sealed-



SHOWER DRAIN

---

NAME: Linear Tileable shower drain—Schluter Kerdi Line  
COLOUR/FINISH: To be finished with T6 marble shower floor tile-  
DIMENSIONS: approx. 2"W x entire length of shower-  
QTY: Contractor to Perform Takeoff's  
NOTES: To be located against wall under shower controls-



CLIENT: Northland Properties - Benchlands Townhomes

EMAIL: lmcintyre@revelstokemountainresort.com

DATE: 2026-03-16

Designer's Rep/Supplier: Kaitlin @ Expressive Interiors - paint@expressiveinteriors.ca

## 2 - WALL FINISHES

---

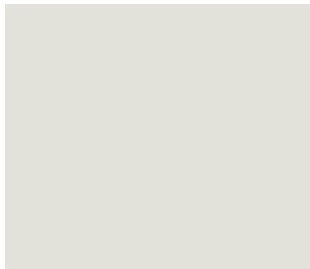

### PT1 - WALL COLOUR

---

NAME: Regal or Ben Paint  
COLOUR/FINISH: Silver Satin - Eggshell Finish  
BRAND: Benjamin Moore  
CODE: OC-26

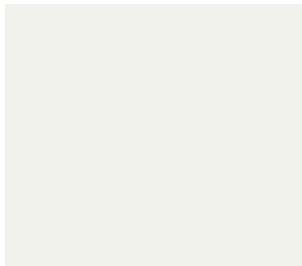

### PT2 - BASE + TRIM COLOUR

---

NAME: Regal or Ben Paint  
COLOUR/FINISH: Oxford White - Satin/Pearl Finish  
BRAND: Benjamin Moore  
CODE: CC-30

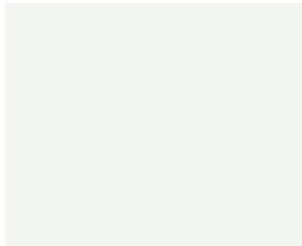

### PT3 - CEILING COLOUR

---

NAME: Waterborne Ceiling Paint  
COLOUR/FINISH: Ceiling White 508 09, Ultra Flat Finish  
BRAND: Benjamin Moore  
CODE: CEIL-WH01



CLIENT: Northland Properties - Benchlands Townhomes

EMAIL: lmcintyre@revelstokemountainresort.com

DATE: 2026-03-16

### 3 - INTERIOR DETAILS

#### WINDOW TRIM

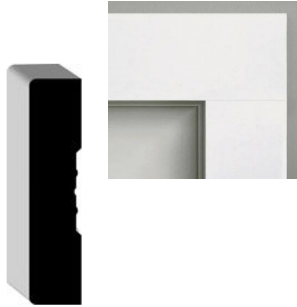

NAME: Primed MDF Casing  
COLOUR/FINISH: Painted PT2  
BRAND: Alexandria Mouldings  
CODE: 90423  
DIMENSIONS: 5/8" x 3" x 16'  
QTY: Contractor to Perform Takeoff's  
NOTES: Can be subbed with alternate brand equivalent if necessary  
INSTALL: Mitered Corners

#### DOOR TRIM

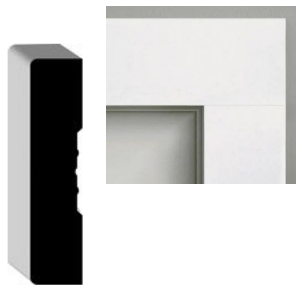

NAME: Primed MDF Casing  
COLOUR/FINISH: Painted PT2  
BRAND: Alexandria Mouldings  
CODE: 90423  
DIMENSIONS: 5/8" x 3" x 16'  
QTY: Contractor to Perform Takeoff's  
NOTES: Can be subbed with alternate brand equivalent if necessary  
INSTALL: Mitered Corners

#### BASEBOARD



NAME: Primed MDF Baseboard  
COLOUR/FINISH: Painted PT2  
BRAND: Alexandria Mouldings  
CODE: 5128  
DIMENSIONS: 1/2" x 5-1/4"  
QTY: Contractor to Perform Takeoff's  
NOTES: Can be subbed with alternate brand equivalent if necessary

#### INTERIOR DOORS

---

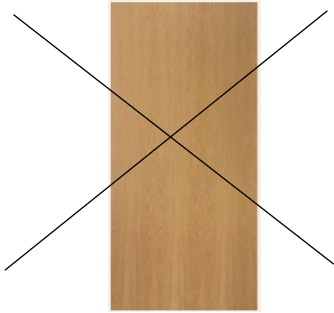

NAME: Slab Style Wood Door  
COLOUR/FINISH: Plain Sliced White Oak with clear satin finish  
BRAND: Lynden Door  
DIMENSIONS: Varies  
QTY: Contractor to Perform Takeoff's  
NOTES: Can be subbed with alternate brand equivalent if necessary  
Solid Core

#### INTERIOR DOORS

---



NAME: Lincoln Single Recessed Panel Interior Door  
COLOUR/FINISH: Solid Core, Painted PT2  
BRAND: Masonite  
DIMENSIONS: Varies  
QTY: Contractor to Perform Takeoff's  
NOTES: Can be subbed with alternate brand equivalent if necessary

#### INTERIOR DOOR HANDLES

---



NAME: Select T-Bar Smooth Lever w/ Disk Rosette  
COLOUR/FINISH: Satin Nickel  
BRAND: Emtek  
CODE: 5209US15.TAUS15.SMUS15.LH, 5209US15.TAUS15.SMUS15.RH, C5209US15.TAUS15.SMUS15  
QTY: Contractor to Perform Takeoff's  
NOTES: Bedroom + Bathrooms - Privacy Style  
Closets - Passage or Dummy Style

#### POCKET DOOR HANDLES

---



NAME: Round Pocket Door Tubular Lock  
COLOUR/FINISH: Satin Nickel  
BRAND: Emtek  
CODE: 2145US15  
DIMENSIONS: 2-3/8" round  
QTY: Contractor to Perform Takeoff's  
NOTES: Privacy Function

#### BYPASS SLIDING DOOR HANDLES

---



NAME: Round Flush Pull  
COLOUR/FINISH: Satin Nickel  
BRAND: Emtek  
CODE: 221115  
DIMENSIONS: 1-1/2" diam  
QTY: Contractor to Perform Takeoff's  
NOTES:



**DOOR HINGES**

---

NAME: Residential Duty Steel, Plain Bearing Hinge  
COLOUR/FINISH: Satin Nickel  
BRAND: Contractor preferred  
DIMENSIONS: 3-1/2" x 3-1/2"  
QTY: Contractor to Perform Takeoff's  
NOTES: 1/4" radius corners

**STANDARD CLOSET DETAILS**

---



NAME: Custom floating shelves w/ rods below  
SHELVES: Custom floating shelves  
MATERIAL: White oak veneer  
FINISH: Clear satin finish to match MW1  
SIZE: Approx. 2" thk. x 14" deep  
QTY: Contractor to Perform Takeoff's  
RODS: Heavy duty hanging rod  
MATERIAL: Stainless steel  
SIZE: approx. 1-1/2" heavy-duty  
QTY: Contractor to Perform Takeoff's



**M1 - MIRROR (Bathrooms 1 + 2)**

---

NAME: MR802436S  
COLOUR/FINISH: Silver  
BRAND: Elegant Furniture & Lighting  
CODE: MR802436S  
DIMENSIONS: 24"W x 36"H  
QTY: Contractor to Perform Takeoff's (1 Per Bathroom)

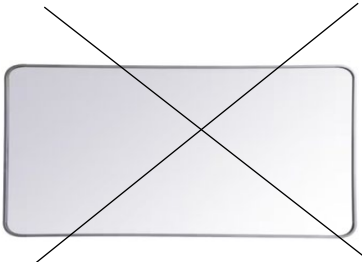

~~M2 - MIRROR (Bathroom 3)~~

---

~~NAME: MR803060S  
COLOUR/FINISH: Silver  
BRAND: Elegant Furniture & Lighting  
CODE: MR803060S  
DIMENSIONS: 60" x 30"H (confirm vanity size)  
QTY: Contractor to Perform Takeoff's (1 Per Bathroom)~~



**M2 - MIRROR (Bathroom 3, 4 + 5)**

---

NAME: MR1B4230SIL  
COLOUR/FINISH: Brass  
BRAND: Elegant Furniture & Lighting  
CODE: MR1B4230SIL  
DIMENSIONS: 42"W X 30"H  
QTY: Contractor to Perform Takeoff's (1 Per Bathroom)  
NOTES: Centered on double vanity

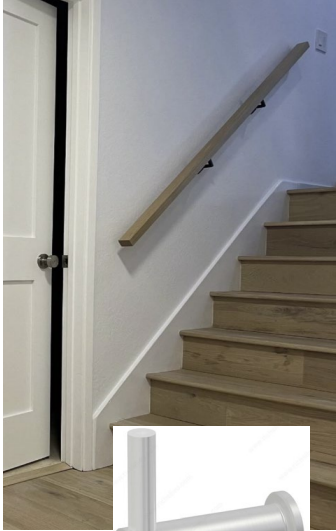

## STAIR DETAILS

---

TREAD:	H1 Closed hardwood tread installed seamlessly with main flooring
NOSING:	H1 Custom made flush hardwood nosing made by flooring supplier
RISER:	H1 Hardwood riser
STRINGER:	If stringer is required, paint PT2 to match baseboard.
NOTES:	

## HANDRAIL DETAILS

---

HANDRAIL:	Standard square wood handrail with eased edges.
FINISH:	Clear finish to match MW1
BRACKET:	Richelieu Stainless Steel Round Wall Mount Height-Adjustable Bracket #SSWF0010016S

## WINDOW COVERINGS - BLINDS

---

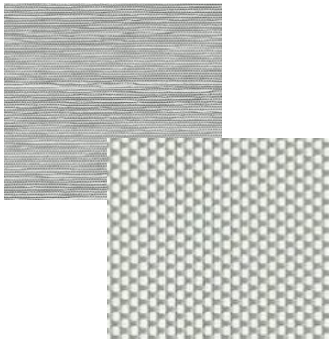

NAME:	Manual Rolls - Black Out + 1% Screen
COLOUR/FINISH:	Blackout - Vail Grey RB19 01 1% Screen - Nordic Screen Plus White/Grey RS23 06
BRAND:	Alta
DIMENSIONS:	Varies
QTY:	Supplier to preform takeoff
NOTES:	Roller style - manual lift (no cords) Inside Mount, Cassette w/ Matching Fabric Light Filtering in Living Spaces, Blackout in Bedrooms <i>Limited fabric options due to size restrictions</i>

## WINDOW COVERINGS - OPTIONAL UPGRADE AVAILABLE

---

NAME:	Motorized cell or roll option with battery pack
COLOUR/FINISH:	Blackout - Light filtering -
BRAND:	Alta
DIMENSIONS:	Varies
QTY:	Supplier to preform takeoff
NOTES:	<i>More colour options available</i> Inquire through supplier



CLIENT: Northland Properties - Benchlands Townhomes

EMAIL: lmcintyre@revelstokemountainresort.com

DATE: 2026-03-16

#### 4 -MILLWORK



MW1 - CABINET DOOR/DRAWER (*Bathroom vanities, kitchen open cabinet, kitchen island and feature millwork*)

STYLE: Slab Style, Rift Cut White Oak (wood/veneer)

OUTSIDE PROFILE: Square

COLOUR/FINISH: 15 Degree Sheen Clear Top Coat

NOTES: Vertical Grain

\*\*\*Please supply any alternate product sample to designers for approval

Feature millwork areas to include kitchen open cabinet, back of island flutes, mudroom, laundry, office, dining nook and closets.



MW1.2 - ISLAND BACK DETAIL

STYLE: Fluted island back detail, white oak

COLOUR/FINISH: White Oak with Clear Finish (To match MW1)

BRAND: Custom

DIMENSIONS: approx. 1" flutes

NOTES: \*\*\*Please supply any alternate product sample to designers for approval



MW2 - CABINET DOOR/DRAWER (*Kitchen lowers + fridge panels/cabinet*)

STYLE: Slab Style, painted

OUTSIDE PROFILE: Square

COLOUR: Porch Swing CSP-750 (Benjamin Moore)

FINISH: 15 Degree Sheen

NOTES: \*\*\*Please supply any alternate product sample to designers for approval

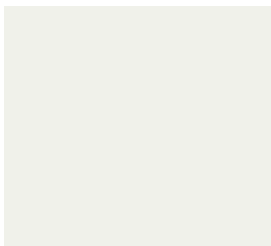

MW3 - CABINET DOOR/DRAWER (*Kitchen uppers + custom hood fan*)

STYLE: Slab Style, painted

INSIDE PROFILE: N/A

OUTSIDE PROFILE: Square

COLOUR/FINISH: Oxford White CC-30 (Benjamin Moore)

BRAND: Custom

NOTES: \*\*\*Please supply any alternate product sample to designers for approval



#### MW4 - CABINET MATERIAL *(Pantry/Closet Units)*

---

STYLE: Slab Style, TFL Panels  
 OUTSIDE PROFILE: Square  
 COLOUR: Millworker's standard white, TFL panels for cost savings  
 FINISH:  
 NOTES: \*\*\*Please supply any alternate product sample to designers for approval

### 5 -HARDWARE

---

#### HW1 - CABINET PULLS *(Drawers + Pantry)*

---



NAME: Select Rectangular Smooth Cabinet Pull  
 COLOUR/FINISH: Satin Nickel  
 BRAND: Emttek  
 CODE: 84056.RECUS15.SMUS15  
 DIMENSIONS: 8"  
 QTY: Millworker to Perform Takeoff's

#### HW2 - CABINET KNOBS *(Upper Doors)*

---



NAME: Select Rectangular Smooth Cabinet Finger Pull  
 COLOUR/FINISH: Satin Nickel  
 BRAND: Emttek  
 CODE: 86658.RECUS15.SMUS15  
 DIMENSIONS: 1 1/2"  
 QTY: Millworker to Perform Takeoff's

#### HW3 - APPLIANCE PULL *(Fridge doors + drawer)*

---



NAME: Select Rectangular Smooth Appliance Pull  
 COLOUR/FINISH: Satin Nickel  
 BRAND: Emttek  
 CODE: 84072.RECUS15.SMUS15, CS84072.RECUS15.SMUS15, BTB84072.RECUS15.SMUS15  
 DIMENSIONS: 24"  
 QTY: Millworker to Perform Takeoff's (3 per unit)

#### HW4 - APPLIANCE PULL *(Dishwasher)*

---

NAME: Select Rectangular Smooth Appliance Pull  
 COLOUR/FINISH: Satin Nickel  
 BRAND: Emttek  
 CODE: 84071.RECUS15.SMUS15, CS84071.RECUS15.SMUS15, BTB84071.RECUS15.SMUS15  
 DIMENSIONS: 18"  
 QTY: Millworker to Perform Takeoff's (1 per unit)



CLIENT: Northland Properties - Benchlands Townhomes

EMAIL lmcintyre@revelstokemountainresort.com

DATE: 2026-03-16

Designer's Rep/Supplier: Lise Paradis @ HanStone - lparadis@hanstone.ca

## 6 - COUNTERS

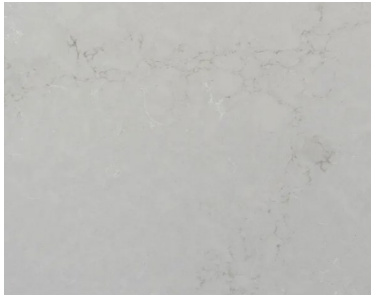

### CT1 - QUARTZ COUNTERS

NAME: Engineered Quartz

COLOUR/FINISH: Awaken - Polished Finish

BRAND: HanStone Quartz

DIMENSIONS: 3cm THK.

NOTES: Square Edge

\*\*\*Please supply any alternate product sample to designers for approval



### CT1 - QUARTZ PARTIAL (*Kitchen Backsplash*)

NAME: Engineered Quartz

COLOUR/FINISH: Awaken - Polished Finish

BRAND: HanStone Quartz

DIMENSIONS: 3cm THK. - approx. 10" height (to be confirmed w/ drawings)

NOTES: Square Edge

NOTES: Quartz to have small, 1.5"D cap on top for tile to sit on. (same detail as image)

\*\*\*Please supply any alternate product sample to designers for approval

Detail in main house only, not suite

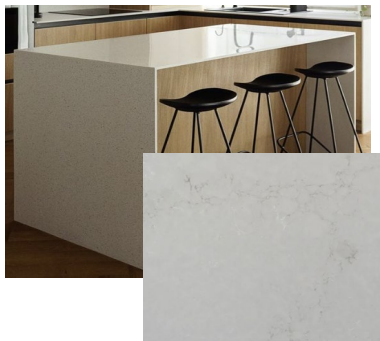

### CT1 - KITCHEN COUNTER WATERFALL (*Island*)

NAME: Engineered Quartz

COLOUR/FINISH: Awaken - Polished Finish

BRAND: HanStone Quartz

DIMENSIONS: See drawings for details - 3cm thk.

NOTES: Square Edge

NOTES: Waterfall detail on both sides of island

\*\*\*Please supply any alternate product sample to designers for approval

**POWDER BATH BACKSPLASH** (*Bath 1*)

---

NOTES: No backsplash in powder baths - T2 feature wall tile behind



**CT1 - 4" MATCHING QUARTZ BACKSPLASH** (*Bath 2 only*)

---

NAME: Engineered Quartz  
COLOUR/FINISH: Awaken - Polished Finish  
BRAND: HanStone Quartz  
DIMENSIONS: 3cm THK. - 4" height  
NOTES: Square Edge  
NOTES: Backsplash to align with vanity on back wall only  
\*\*\*Please supply any alternate product sample to designers for approval

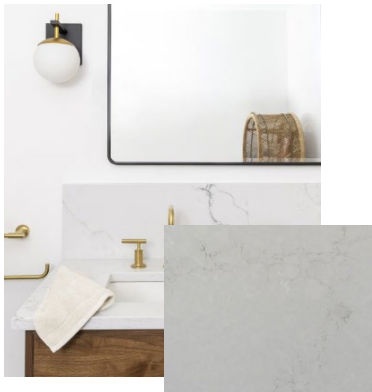

**CT1 - 8" MATCHING QUARTZ BACKSPLASH** (*Bath 3, 4 + 5*)

---

NAME: Engineered Quartz  
COLOUR/FINISH: Awaken - Polished Finish  
BRAND: HanStone Quartz  
DIMENSIONS: 3cm THK. - 8" height  
NOTES: Square Edge  
NOTES: Backsplash to run along back wall of vanity only.  
\*\*\*Please supply any alternate product sample to designers for approval



**CT1 - QUARTZ NICHE FRAMES** (*Bathroom 2, 3, 4 + 5*)

---

NAME: Engineered Quartz  
COLOUR/FINISH: Awaken - Polished Finish  
BRAND: HanStone Quartz  
SUPPLIER: Contractor to determine  
NOTES: Square Edge

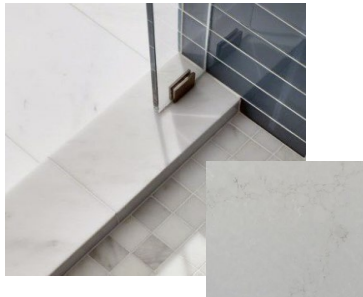

**CT1 - QUARTZ THRESHOLD**

---

NAME: Engineered Quartz  
COLOUR/FINISH: Awaken - Polished Finish  
BRAND: HanStone Quartz  
SUPPLIER: 3cm THK.  
NOTES: Square Edge



**CT2- BUTCHER BLOCK COUNTERS** (*Pantry + Laundry*)

---

NAME: Butcher Block counters  
COLOUR/FINISH: Solid maple, clear polyurethane finish  
BRAND: Custom by millworker  
DIMENSIONS: 1-1/2" thk, approx. 3" wide laminations  
NOTES: Square Edge



SPRUCE + ARROW  
INTERIOR DESIGN STUDIO

CLIENT: Northland Properties - Benchlands Townhomes

EMAIL: lmcintyre@revelstokemountainresort.com

DATE: 2026-03-16

Designer's Rep/Supplier: Lauren Valhalla @ Splashes/Andrew Sheret Salmon Arm - lauren.valhalla@sheret.com

## 7 - PLUMBING



### KITCHEN FAUCET

NAME: Odin Pull-Down Faucet with Square Spout  
COLOUR/FINISH: Brilliance Stainless  
BRAND: Brizo  
CODE: 63065LF-SSLHP + HLK175-SS (handle)  
DIMENSIONS: 14-5/8"H x 9"D x 3-1/8"W  
QTY: Contractor to Perform Takeoff's



### KITCHEN SINK

NAME: Precision U 2  
COLOUR/FINISH: 18-gauge stainless steel  
BRAND: Blanco  
CODE: 400399  
DIMENSIONS: 32"W x 18"D x 10"H  
QTY: Contractor to Perform Takeoff's  
NOTES: Undermount Install



### KITCHEN SINK *(Suite Only if required)*

NAME: Precision U 1  
COLOUR/FINISH: Stainless Steel  
BRAND: Blanco  
CODE: 400397  
DIMENSIONS: 19"W x 18"D  
QTY: Contractor to Perform Takeoff's



### VANITY SINK *(All bathrooms)*

NAME: Atherton Under Counter Lavatory  
COLOUR/FINISH: Cotton White  
BRAND: Toto  
CODE: LT221#01  
DIMENSIONS: 17"W x 13"D x 4"D  
QTY: Contractor to Perform Takeoff's



**BATHROOM FAUCET** *(Bathroom 1 + 2)*

---

NAME: Allaria Single-Handle Lavatory Faucet  
COLOUR/FINISH: Brilliance Luxe Nickel  
BRAND: Brizo  
CODE: 65067LF-NK-ECO  
QTY: Contractor to Perform Takeoff's

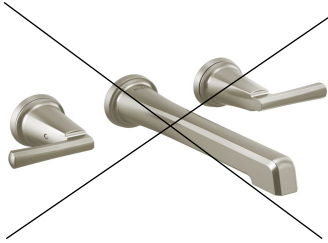

~~**BATHROOM FAUCET** *(Primary Bathroom -1)*~~

---

~~NAME: Levoir Two-Handle Wall Mount Lavatory Faucet  
COLOUR/FINISH: Brilliance Luxe Nickel  
BRAND: Brizo  
CODE: T65898LF-NKLHP-ECO + HL5898-NK (lever handles) + R65800-  
(two-handle lavatory rough)  
QTY: Contractor to Perform Takeoff's (2 per bathroom)~~



**BATHROOM FAUCET** *(Primary Bathroom 3, 4 + 5)*

---

NAME: Allaira Widespread Lavatory Faucet with Square Spout  
COLOUR/FINISH: Brilliance Luxe Nickel  
BRAND: Brizo  
CODE: 65368LF-NKLHP-ECO (faucet less handles) + HL5368-NK (handle kit)  
QTY: Contractor to Perform Takeoff's (2 per bathroom)



**STANDARD SHOWER SYSTEM** *(In all locations with showers - Bath 2, 3 + 4)*

---

NAME: Essential Shower Series -  
1 Linear Round Slide Bar With Hose  
2 Linear Round H2Okinetic Single Function Handshower  
3 16" Linear Round Wall Mount Shower Arm And Flange  
4 12" Linear Round Single-Function Raincan Shower Head  
5 Levoir Pressure Balance Valve with Integrated 3-Function Diverter Trim

COLOUR/FINISH: Brilliance Luxe Nickel  
BRAND: Brizo  
CODE: 1 74792-NK (Linear Round Slide Bar w/ Hose)  
2 RP73147NK (handshower)  
3 RP71648NK (shower arm and flange)  
4 81392-NK (rain shower head)  
5 T75P598-NKLHP (trim) + HL75P75-BN (handles) + R75000 (rough)

QTY: Contractor to Perform Takeoff's

NOTES: Valve mounted on a different wall than fixtures are located - see drawings for detail

**STANDARD TUB/SHOWER SYSTEM** *(In Bath 2 with tub/shower combo units/alcove tubs)*



**NAME:** Essential Shower Series -  
 1 Linear Round Slide Bar With Hose  
 2 Linear Round H2Okinetic Single Function Handshower  
 3 16" Linear Round Wall Mount Shower Arm And Flange  
 4 12" Linear Round Single-Function Rain can Shower Head  
 5 Levoir TempAssure Thermostatic Valve With Integrated 6-Function Diverter Trim  
 6 Linear Round Diverter Tub Spout

**COLOUR/FINISH:** Brilliance Luxe Nickel

**BRAND:** Brizo

**CODE:** 1 74792-NK (Linear Round Slide Bar w/ Hose)  
 2 RP73147NK (handshower)  
 3 RP71648NK (shower arm and flange)  
 4 81392-NK (rain shower head)  
 5 T75698-NK (trim) + R75000 (rough)  
 6 RP81438NK (tub spout)

**QTY:** Contractor to Perform Takeoff's

**NOTES:** Valve mounted on a different wall than fixtures are located - see drawings for detail

**ROMAN TUB SPOUT** *(Bathroom 3, 4 + 5)*



**NAME:** Levoir Roman Tub Faucet With Handshower

**COLOUR/FINISH:** Brilliance Luxe Nickel

**BRAND:** Brizo

**CODE:** T67498-NKLHP (filler) +HL698-NK (handles) + R64707 (rough)

**QTY:** Contractor to Perform Takeoff's

~~**FREESTANDING TUB** *(Bathroom 3 + 4)*~~



~~**NAME:** Glace Flash Freestanding Tub w/ White Drain (For deck-mount/roman tub filler)~~

~~**COLOUR/FINISH:** White High-Gloss Acrylic~~

~~**BRAND:** Look Bath~~

~~**CODE:** 4028205 (Sheret code)~~

~~**DIMENSIONS:** 67" x 31.5" x 22 4/5"~~

~~**QTY:** Contractor to Perform Takeoff's~~

~~**NOTES:** Offset center drain~~

**FREESTANDING TUB** *(Bathroom 3, 4 + 5)*



**NAME:** Eldora 5832 AcrylX Freestanding Center Drain Bathtub

**COLOUR/FINISH:** White

**BRAND:** Maax

**CODE:** 106992-000-002-100

**DIMENSIONS:** 58"L x 32"W x 23"H

**QTY:** Contractor to Perform Takeoff's

**NOTES:** Offset Center Drain. 1 Tub - 2 Pieces

ALCOVE TUB (Bathroom 2 where tub is noted)



NAME: Rubix 6032 Alcove Tub with Double Tiling Flange  
COLOUR/FINISH: White  
BRAND: Maax  
CODE: 6452328 (Sheret code)  
DIMENSIONS: 60"W x 32"D  
QTY: Contractor to Perform Takeoff's  
NOTES: Contractor to determine if RH or LH drain is required.

CURTAIN ROD (Bathroom 2 where tub is noted)



NAME: Straight Shower Rod - Round Blacking  
COLOUR/FINISH: Satin Finish  
BRAND: Kartners  
CODE: KSR-5SS/ KSR-6SS  
DIMENSIONS: 60"  
QTY: Contractor to Perform Takeoff's  
NOTES: Reach out to Lauren @ Splashes for rod details.



SHOWER DOOR - SLIDING (Bathroom 2, 3 + 4)

NAME: Custom Frameless Shower Glass w/ Sliding Door  
COLOUR/FINISH: Satin Nickel Hardware  
DIMENSIONS: as per ID drawings  
QTY: Contractor to Perform Takeoff's  
NOTES: Fixed door located on showerhead side.

SHOWER DOOR - SLIDER w/ RETURN (Bathroom 5)

NAME: Custom Frameless Shower Glass w/ Swing Door  
COLOUR/FINISH: Brushed Brass Hardware  
DIMENSIONS: as per ID drawings  
QTY: Contractor to Perform Takeoff's  
NOTES: Fixed panel located on shower head side & return, door location closest to glass return



SHOWER DOOR - SWING w/ RETURN (Bathroom 5)

NAME: Custom Frameless Shower Glass w/ Swing Door  
COLOUR/FINISH: Satin Nickel Hardware  
DIMENSIONS: Approx. 48"W X 36" x 77"H  
QTY: Contractor to Perform Takeoff's  
NOTES: Fixed panel located on shower head side & return, door location closest to glass return



SHOWER SHIELD - OPTION 2 (Bathroom 3)

NAME: Custom Frameless Fixed Panel Shower Glass  
COLOUR/FINISH: Satin Nickel Hardware  
DIMENSIONS: Approx. 36" W x 77" H (prefer floor to ceiling)  
QTY: Contractor to Perform Takeoff's  
NOTES: Fixed panel located on showerhead side.



OPTIONAL SHOWER DOOR (Bathroom 4)

NAME: Custom Shower Glass, Frameless Swing Door  
COLOUR/FINISH: Satin Nickel Hardware  
DIMENSIONS: Approx. 26" - 30" wide x 72" ht  
QTY: Contractor to Perform Takeoff's  
NOTES: See drawings to confirm hinge side

TOILET



NAME: Nexus Elongated ADA Toilet Bowl w/ Tornado Flush, Nexus 4.8L Toilet Tank and Soft Close Elongated Toilet Seat + Lid  
COLOUR/FINISH: White  
BRAND: Toto  
CODE: 1061220 (Sheret code) Toilet Tank  
1061210 Toilet Bowl  
1060845 Seat  
QTY: Contractor to Perform Takeoff's  
NOTES: Order w/ Trip Lever - THU750#BN

BATHROOM HARDWARE/ACCESSORIES

TOWEL BAR



NAME: Allaria 24" Towel Bar  
COLOUR/FINISH: Brilliance Luxe Nickel  
BRAND: Brizo  
CODE: 692467-NK  
DIMENSIONS: 24" c to c  
QTY: Contractor to Perform Takeoff's

HAND TOWEL HOOK



NAME: Allaria 8" Towel Bar  
COLOUR/FINISH: Brilliance Luxe Nickel  
BRAND: Brizo  
CODE: 694767-NK  
DIMENSIONS: 8" c to c  
QTY: Contractor to Perform Takeoff's

ROBE HOOK



NAME: Robe Hook  
COLOUR/FINISH: Brilliance Luxe Nickel  
BRAND: Brizo  
CODE: 693467-NK  
QTY: Contractor to Perform Takeoff's (2 per bathroom - location as per drawing)

TISSUE HOLDER

---



NAME: Tissue Holder  
COLOUR/FINISH: Brilliance Luxe Nickel  
BRAND: Brizo  
CODE: 695067-NK  
QTY: Contractor to Perform Takeoff's



CLIENT: Northland Properties - Benchlands Townhomes

EMAIL: lmcintyre@revelstokemountainresort.com

DATE: 2026-03-16

Designer's Rep/Supplier: Trish Wright @ Robinson Lighting Kelowna - Trishw@robinsonlighting.com

## 8 - LIGHTING + ELECTRICAL

### L1 - POTLIGHTS



NAME: Standard 4" pot light  
COLOUR/FINISH: White trim/case  
BRAND: contractor/electrician preferred  
DIMENSIONS: 4" Diam.  
QTY: Electrician to Perform Takeoff's  
NOTES: \*3000K Colour temperature



### L2 - KITCHEN ISLAND/PENINSULA PENDANTS (Group of 3)

NAME: Onyx Dome 07-LA00  
COLOUR/FINISH: Matte Off White (OWM) Shade, Cream Onyx, Cream Cord  
BRAND: Luminaire Authentik  
DIMENSIONS: 7" Shade  
QTY: Contractor to Perform Takeoff's (3 per island/peninsula)



### L2 - KITCHEN ISLAND/PENINSULA PENDANTS (Group of 3)

NAME: Issa 6-in Pendant  
COLOUR/FINISH: White  
BRAND: Kuzco  
CODE: PD418006WH  
DIMENSIONS: D5-5/8" x H12-3/8"  
QTY: Contractor to Perform Takeoff's (3 per island/peninsula)

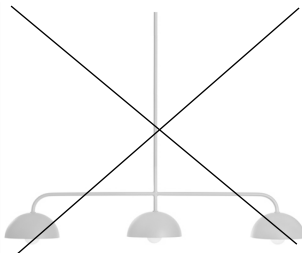

### L3 - DINING ROOM PENDANT

NAME: DOME 07-LA09  
COLOUR/FINISH: Matte Off White (OWM)  
BRAND: Luminaire Authentik  
DIMENSIONS: 43" width x adj. height  
QTY: Contractor to Perform Takeoff's (1 per unit)



**L3 - DINING ROOM PENDANT**

---

NAME: Elsa Linear  
COLOUR/FINISH: Textured White  
BRAND: Mitzi  
CODE: H689906-TWH  
DIMENSIONS: 50"L x 11"W x 8.5"H  
QTY: Contractor to Perform Takeoff's (1 per unit)

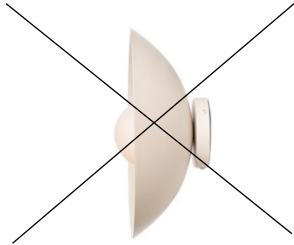

~~L4 - VANITY SCONCE (Bathroom 1 - located above toilet)~~

---

~~NAME: Danoise 1505-LA40  
COLOUR/FINISH: Matte Off White (OWM)  
BRAND: Luminaire Authentik  
DIMENSIONS: 15" Diam.  
QTY: Contractor to Perform Takeoff's~~



**L4 - VANITY SCONCE (Bathroom 1 - located above toilet)**

---

NAME: 1LT Wall Sconce  
COLOUR/FINISH: Matte White with Faux Alabaster Shade  
CODE: BUR-51W-MW-ALB  
DIMENSIONS: 6"W x 6"H  
QTY: Contractor to Perform Takeoff's



**L5 - VANITY SCONCE (Bathroom 2)**

---

NAME: Elmont  
COLOUR/FINISH: Polished Nickel w/ Marble + Opal Glass  
BRAND: Hudson Valley Lighting Group  
CODE: 9204-PN  
DIMENSIONS: 24.75"W x 4.75"H x 6"E  
QTY: Contractor to Perform Takeoff's



**L6 - VANITY SCONCE (Bathroom 3, 4 + 5)**

---

NAME: Elmont  
COLOUR/FINISH: Polished Nickel w/ Marble + Opal Glass  
BRAND: Hudson Valley Lighting Group  
CODE: 9206-PN  
DIMENSIONS: 34.25"W x 4.75"H x 6"E  
QTY: Contractor to Perform Takeoff's (1 per ensuite)

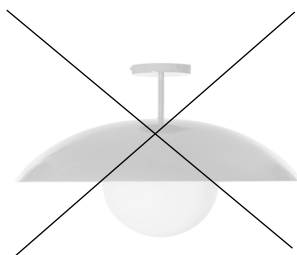

~~L7 - CEILING LIGHT (Bedrooms)~~

---

~~NAME: Danoise  
COLOUR/FINISH: Matte Off White  
BRAND: Luminaire Authentik  
CODE: 2408-LA04  
DIMENSIONS: 24" Diam.  
QTY: Contractor to Perform Takeoff's~~



#### L7 - CEILING LIGHT (*Bedrooms*)

---

NAME: Domo-Glo 24"  
COLOUR/FINISH: Matte White  
CODE: MX2208V21  
DIMENSIONS: 24" Diam. X 20"H  
QTY: Contractor to Perform Takeoff's



#### L8 - STANDARD FLUSH-MOUNT (*As required*)

---

NAME: Aston 14" Flush Mount  
COLOUR/FINISH: Clear  
BRAND: Kuzco  
CODE: FM48614-5CCT  
DIMENSIONS: 14" Diam.  
QTY: Contractor to Perform Takeoff's  
NOTE: As needed in closets, family room, entry, pantry etc. don't have pot lights



#### L9 - ACCENT SCONCES (*As required*)

---

NAME: Asime  
COLOUR/FINISH: Chrome/Marble - Opal Bulbs  
BRAND: Hudson Valley Lighting Group  
CODE: H120102-PM  
DIMENSIONS: 20.75" Ht  
QTY: Contractor to Perform Takeoff's  
NOTES: Stairwell, within dining millwork, office etc.

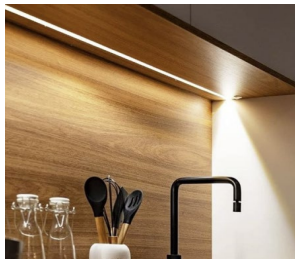

#### L10- UNDER CABINET LIGHTING (*Kitchen*)

---

NAME: LED strip lighting  
COLOUR/FINISH: LED light with frosted cover  
DIMENSIONS: To run entire length of upper cabinets in kitchens  
QTY: Contractor to Perform Takeoff's  
NOTES: 3000K Light Temperature

#### L11 - EXTERIOR SCONCES

---

NAME: To be spec'd by Architect  
QTY: Contractor to Perform Takeoff's (As required)  
NOTE:



**SPRUCE + ARROW**  
 INTERIOR DESIGN STUDIO

CLIENT: Northland Properties - Benchlands Townhomes

EMAIL: lmcintyre@revelstokemountainresort.com

DATE: 2026-03-16

Designer's Rep/Supplier: Dimpy Sanghera @ City Furniture Revelstoke - cityfurniture Revelstoke@gmail.com

**9 - APPLIANCES**

**KITCHENAID OPTION**



RANGE OPTION 1 (Gas)

NAME: 5-Burner Gas Convection Front Control Range  
 COLOUR/FINISH: Stainless Steel  
 BRAND: KitchenAid  
 CODE: KSGG700ESS  
 DIMENSIONS: 30"W x 36"H  
 QTY: Contractor to Perform Takeoff's



RANGE OPTION 2 (Induction)

NAME: 4-Element Induction Slide-In Convection Range w/ Air Fry  
 COLOUR/FINISH: Stainless Steel  
 BRAND: KitchenAid  
 CODE: KSIS730PSS  
 DIMENSIONS: 30"W x 36"H  
 QTY: Contractor to Perform Takeoff's



FRIDGE

NAME: 36"W Built-In Panel Ready French Door Refrigerator  
 COLOUR/FINISH: Panel-Ready  
 BRAND: KitchenAid  
 CODE: KBFN506EPA  
 DIMENSIONS: 83.38"H x 36.25"W x 27.75"D  
 QTY: Contractor to Perform Takeoff's



DISHWASHER

NAME: PrintShield Finish Flush-To-Cabinet Dishwasher w/ FreeFlex Fit Third Level Rack  
 COLOUR/FINISH: Panel-Ready  
 BRAND: KitchenAid  
 CODE: KDTF924PPA  
 DIMENSIONS: standard 24"W  
 QTY: Contractor to Perform Takeoff's

BOSCH OPTION



RANGE OPTION 1 (Gas)

NAME: 800 Series 30" Gas Slide-in Range  
COLOUR/FINISH: Stainless Steel  
BRAND: Bosch  
CODE: HGI8056UC  
DIMENSIONS: 30"W x 36"H  
QTY: Contractor to Perform Takeoff's



RANGE OPTION 2 (Induction)

NAME: Benchmark Series 30" Induction Slide-in Range  
COLOUR/FINISH: Stainless Steel  
BRAND: Bosch  
CODE: HIIP057U  
DIMENSIONS: 30"W x 36"H  
QTY: Contractor to Perform Takeoff's



FRIDGE

NAME: Benchmark Series 36" Built-In Custom Panel French Door  
COLOUR/FINISH: Panel-Ready  
BRAND: Bosch  
CODE: B36IT905NP  
DIMENSIONS: 84"H x 35-3/4"W x 24"D  
QTY: Contractor to Perform Takeoff's



DISHWASHER

NAME: 800 Series 24" Custom Panel Dishwasher  
COLOUR/FINISH: Panel-Ready  
BRAND: Bosch  
CODE: CHV78CM3N  
DIMENSIONS: Standard 24"W  
QTY: Contractor to Perform Takeoff's

RECESSED HOOD FAN



NAME: Q2 30" Insert  
COLOUR/FINISH: Stainless Steel  
BRAND: Victory Range Hoods  
DIMENSIONS: 29-1/8"W x 14-1/2"H x 15"D  
QTY: Contractor to Perform Takeoff's  
NOTE: Can customize CFM, venting size + venting direction

## BUILT-IN MICROWAVE

---



NAME: 300 Series Built-in Microwave Oven 24"  
COLOUR/FINISH: Stainless Steel  
CODE: HMB30155UC  
BRAND: Bosch  
DIMENSIONS: 13 5/8" x 24 3/8" x 19 11/16"  
QTY: Contractor to Perform Takeoff's

## WASHER

---



NAME: 5.2 cu. Ft. Smart Front Load Energy Star Cert. Washer w/  
FreshFlow Vent System  
COLOUR/FINISH: Radiant Silver  
BRAND: Whirlpool  
CODE: WFW5720RR  
DIMENSIONS: 31.56"D x 39"H x 27"W  
QTY: Contractor to Perform Takeoff's

## DRYER

---



NAME: 7.4 cu. Ft. Smart Front Load Energy Star Cert. Dryer w/  
Wrinkle Shield Option  
COLOUR/FINISH: Radiant Silver  
BRAND: Whirlpool  
CODE: YWED5720RR  
DIMENSIONS: 31.56"D x 39"H x 27"W  
QTY: Contractor to Perform Takeoff's

## PEDESTALS (Optional)

---



NAME: 15.5" Pedestal for Front Load Washer and Dryer w/  
Storage  
COLOUR/FINISH: Radiant Silver  
BRAND: Whirlpool  
CODE: WFP2715RR  
DIMENSIONS: 27.31"D x 15.5"H x 27"W  
QTY: Contractor to Perform Takeoff's (2 per unit: 1 washer, 1 dryer)

SUITE APPLIANCES (AS REQUIRED)

---



RANGE

---

NAME: 24" Freestanding Electric Range  
COLOUR/FINISH: Stainless Steel  
BRAND: Frigidaire  
CODE: FCFE242CAS  
DIMENSIONS: 23-1/2"W x 23-5/8"D x 36"H  
QTY: Contractor to Perform Takeoff's



FRIDGE

---

NAME: Bottom Freezer Refrigerator  
COLOUR/FINISH: Brushed Steel  
BRAND: Frigidaire  
CODE: FRBG1224AV  
DIMENSIONS: 23-3/5"W x 27-1/5"D x 72-4/5"H  
QTY: Contractor to Perform Takeoff's



OTR MICROWAVE/HOOD FAN COMBO

---

NAME: 24" Over-The-Range Microwave  
COLOUR/FINISH: Stainless  
BRAND: Frigidaire  
CODE: UMV1422U S  
DIMENSIONS: 17"H x 23-7/8"W x 16-3/16"D  
QTY: Contractor to Perform Takeoff's



CLIENT: Northland Properties - Benchlands Townhomes

EMAIL: lmcintyre@revelstokemountainresort.com

DATE: 2026-03-16

10 - FIREPLACE

FIREPLACE

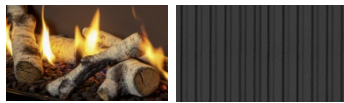

NAME: LT1 Direct Vent Gas Fireplace-  
COLOUR/FINISH: Black  
BRAND: Valer  
CODE: 2500KN/KP  
DIMENSIONS: 40" w x 17 1/2" h viewing area  
QTY: Contractor to Perform Takeoff's  
NOTES: Birch Logs (1505BLK/V2) + Fluted Black Liner (2515FBL)  
Install w/ 1" adjustable finishing trim

FIREPLACE



NAME: Essence 45 Gas FP  
COLOUR/FINISH: Black  
BRAND: Savannah Heating Products  
CODE:  
DIMENSIONS: 39.23" w x 18 1/2" h viewing area  
QTY: Contractor to Perform Takeoff's  
NOTES: Clean Face (No Surround)  
DWLS 7PC Log set

STONE

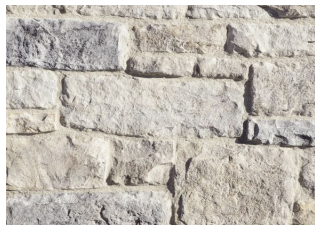

NAME: Limestone (Cultured Stone)  
COLOUR/FINISH: Grand Banks  
BRAND: Eldorado Stone  
DIMENSIONS: 4"-20.375"H x 1.5"-12.5" L x .625"-2.25"Thk.  
QTY: Contractor to Perform Takeoff's  
GROUT: Off-White/Light Grey Grout Colour



MANTEL

NAME: Oak Veneer Mantel  
COLOUR/FINISH: To Match MW1  
DIMENSIONS: TBC with drawings. Approx. 5"H x 4"D  
QTY: Contractor to Perform Takeoff's